

**VAREC 220 Series**  
ROOF MANWAY COVER

The 220 Series is designed for use on tanks where quick and easy personnel access is desired.

**Introduction**

The Varec 220 Series Roof Manway Covers are designed for quick, easy access to storage tanks. They are designed for working pressures up to 1 psig [6.9 kPa].

**Features**

The cover is held closed by quick-opening cast wing nuts which facilitate rapid entry to the tank. Two configurations are provided for even load distribution of the seating surfaces. The 18" and 20" sizes incorporate a rigid center, while the 24", 30" and 36" sizes have a multiple number of hinged lugs and wing nuts for even load distribution. Both configurations include an extra heavy, compliant cover insert to ensure a gas-tight seal and non-sparking operation. The large 36" size allows quick and easy tank access to personnel equipped with breather packs.

The design and construction materials provide a rugged yet lightweight cover which is easy to handle. Varec 220 Series covers are constructed of cast iron base and cover with brass yokes and wing nuts. Also, the 18" and 20" covers have a fabricated steel center beam. 356 T6 cast aluminum and stainless steel construction is available. All covers incorporate tallow impregnated flax cover inserts and flanged bases for mounting. The roof manway covers are available in sizes 18" through 36".



**Technical Data**

- Easy access
- Even load distribution design
- Gas-tight seal
- Non-sparking
- 18", 20", 24", 30", 36" sizes available
- Available in Aluminum, Cast Iron & Stainless Steel Construction

**Connections**

Base is drilled for bolting  
Steel base for welding only (undrilled)

**Materials of Construction**

Base	Cover
Cast Iron	Cast Iron
Aluminum	Aluminum
Carbon Steel	Cast Iron
316 Stainless Steel	316 Stainless Steel

**Wing Nuts**

Brass

**Insert**

Tallow Treated Flax Insert

NOTE:  
Consult your sales representative for other materials.

**Specifications**

**Dimensions and Weights, inches [mm] and lbs. (kg)**

Size Code	18	20	24	30	36
<b>A</b> Opening Size	17 <sup>3</sup> / <sub>4</sub> [451]	19 <sup>7</sup> / <sub>8</sub> [505]	24 [610]	30 <sup>1</sup> / <sub>4</sub> [768]	35 <sup>13</sup> / <sub>16</sub> [910]
<b>B</b> Flange Diameter	23 [584]	26 [660]	33 <sup>1</sup> / <sub>4</sub> [845]	36 <sup>1</sup> / <sub>2</sub> [927]	45 <sup>1</sup> / <sub>2</sub> [1156]
<b>C</b> Diameter Bolt Circle	21 <sup>1</sup> / <sub>4</sub> [540]	23 <sup>1</sup> / <sub>4</sub> [591]	30 <sup>1</sup> / <sub>4</sub> [768]	33 <sup>3</sup> / <sub>4</sub> [857]	42 <sup>1</sup> / <sub>4</sub> [1073]
<b>D</b> Height	7 <sup>7</sup> / <sub>8</sub> [200]	8 [203]	6 <sup>1</sup> / <sub>8</sub> [156]	6 <sup>1</sup> / <sub>8</sub> [156]	6 <sup>1</sup> / <sub>2</sub> [165]
Number of Holes	28	32	28	36	42
Diameter of Holes	<sup>9</sup> / <sub>16</sub> [14]	<sup>9</sup> / <sub>16</sub> [14]	<sup>11</sup> / <sub>16</sub> [17]	<sup>11</sup> / <sub>16</sub> [17]	<sup>7</sup> / <sub>8</sub> [22]
Number of Lugs	1	1	3	4	4
Approximate Shipping Weight	100 (45)	130 (59)	200 (91)	275 (125)	375 (170)

Shipping weights shown for iron construction.  
Dimensions are for preliminary general information and should not be used for construction purposes. Certified dimensional drawings are available upon request.

18" AND 20" SIZES

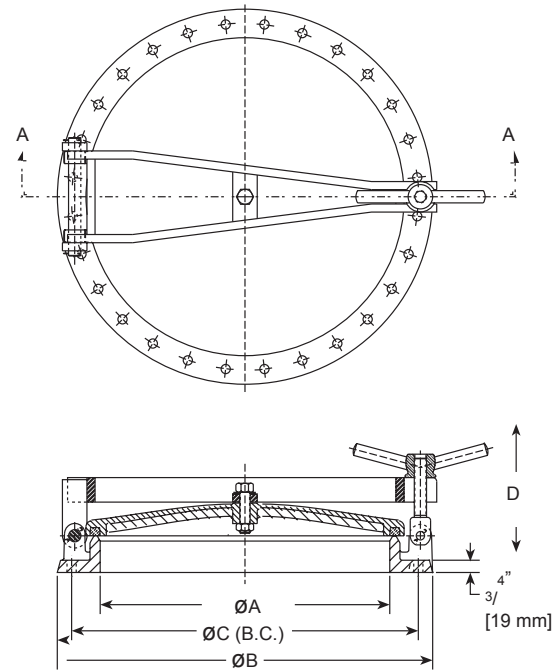

24", 30" AND 36" SIZES

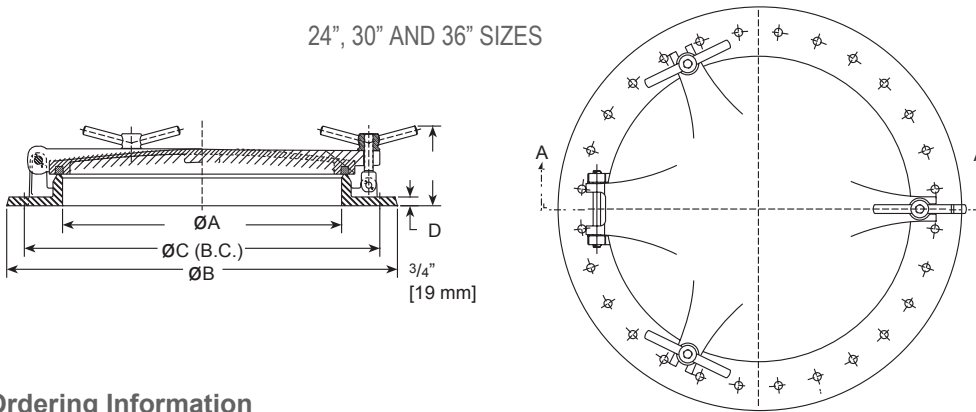

**Ordering Information**

Model	Description
220	Roof Manway
	<b>Code</b> <b>Size</b>
	18              18"
	20              20"
	24              24"
	30              30"
	36              36"
	<b>Code</b> <b>Material</b>
	11              Aluminum Base and Cover with Flax Insert
	22              Iron Base and Cover with Flax Insert
	32              Steel Base and Iron Cover with Flax Insert
	66              Stainless Steel Base and Cover with Flax Insert

220      36      22      (Example)  
Example: 36" Roof Manway Cover, Iron Base and Cover with Flax Insert.